



765 Westminster Street, Providence, RI 02903; 401-273-3300; fax 401-273-3328; www.equipex.com

OVEN DOOR REMOVAL

The Sodir Models FC-60, FC-60/1, FC-60G and FC-60G\1 are equipped with a double glass door which is easily removable for cleaning. For cleaning, remove the door following the steps below:

1. Open the door completely



2. Apply gentle downward pressure on the top of the door while moving each hinge lock to "UP" position, engaging the "J" hook of the long arm (one lock per hinge)

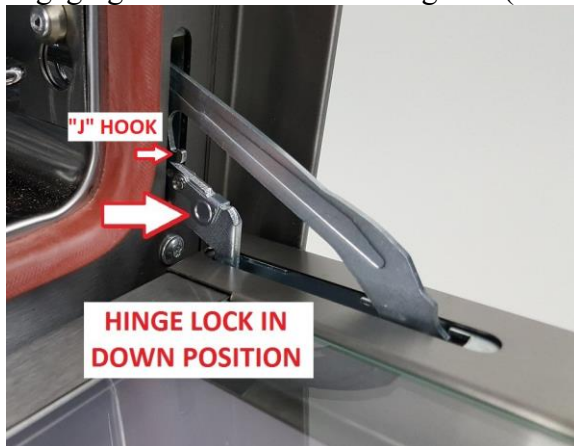

3. Tilt the door up at a 45-60 degree angle (hinge lever arm will be released)



4. Pull the door out of the hinge slot



*NOTE: What hinge looks like in the open position



Upon removal, the door can be washed or cleaned, both on the inside and on the outside

OVEN DOOR INSTALLATION

1. Insure that the notch on the bottom of the hinge fits onto the lip in the opening of the oven frame



2. Move the hinge lock to the “down” position to restore proper hinge operation

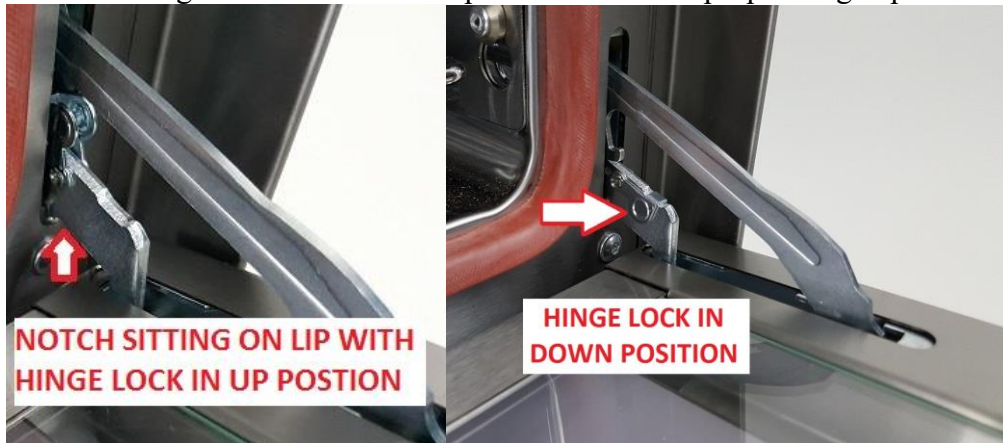

3. Do NOT leave the Hinge lock in the “UP” position at the end of installation

NOTE: Incorrect hinge installation positions

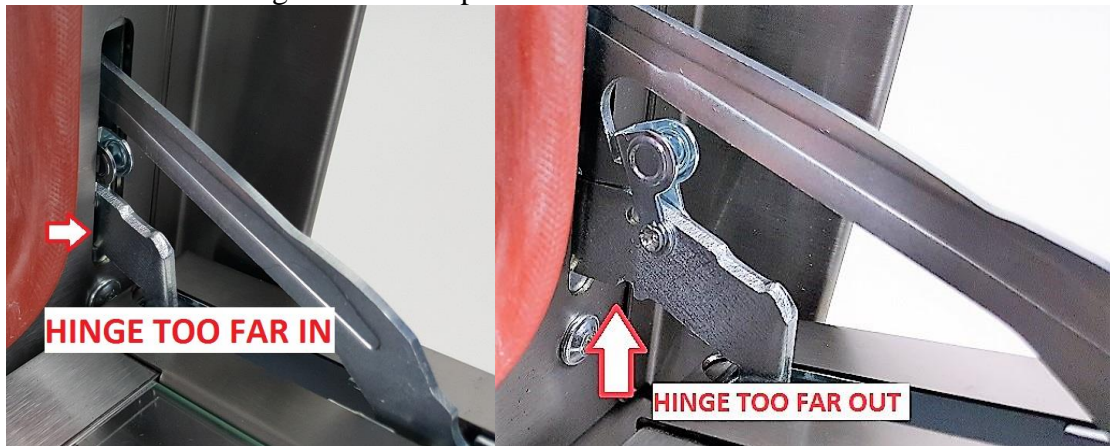

OVEN DOOR INSTALLATION COMPLETE

NOTE: Door should be level at the top edge to verify it has been installed properly

