



Project _____
 Item # _____ Quantity _____
 Model # _____



**Custom Cabinet with Built-In Induction
 Warmer and SmartStone® Top**

Model #	Voltage	Peak Power	Plug Type
SRC-181SS (US)	110-120	1800 W	NEMA 5-15P

Description:

Spring USA's Custom Cabinet with Built-In Induction Warmer and SmartStone® Top is a heating unit for product cooking or holding with a separate control panel. Each range includes our exclusive SmartScan® technology with over/under voltage protection, pan size and pan type recognition, and large LED power/temp display.

Construction & Performance Features:

- Magnetic SmartScan® technology heats the serving vessels, not the countertop
- Sealed induction base with flanged cooking surface for easy mounting under countertop
- Separate control panel with 36" cable for easy mounting
- Rugged, 5 mm thick, easy to clean, tempered glass top
- 100% silicone rubber protective top seal
- Choice of (20) SmartStone® colors
- Choice of (8) laminates or (9) wood stains

- Power ON/OFF heavy duty knob
- Power ON/Pan-Present indicator lights
- Two functions: 'Cook' or 'Temp' mode
- 'Cook'/'Temp' mode touch pad control
- 'Cook'/'Temp' mode indicator lights
- Simple, knob-set thermostat control
- Lighted temperature indicator
- Power level 1-20 in 'Cook' mode
- Temperature range 110°F-400°F (43°C-204°C) in 'Temp' mode

Standard Warranty:

Spring USA Induction Ranges offer a one (1) year exchange warranty, from the date of invoice, against manufacturers defects. See SpringUSA.com for more details.

Agency Listings:

- ETL
- FCC
- CETL
- ETL-Sanitation to NSF-4





Project _____

Item # _____ Quantity _____

Model # _____

**Custom Cabinet with Built-In Induction
Warmer & SmartStone®**

Available Accessories/Alternate Configurations:

- Induction-ready Cookware and Serving Vessels [Spring USA Catalog]
- Built-In, High Power Induction Ranges [See Spec. SIR-3]
- Countertop, Portable Induction Ranges [See Spec. SIR-1]
- Mobile & Custom Configurations [Contact Spring USA]

Electric Requirements:

Model #	Voltage	Phase	Hertz	Watts	Amps	Plug
SRC-181SS (US)	110-120	1	60	1800	15.0	NEMA 5-15P

Key Dimensions:

TOP VIEW

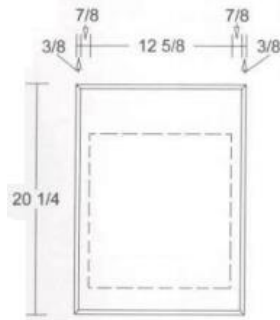

Net Weight: 11.0 lb. (5.0 kg)

FRONT VIEW

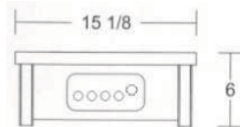

SIDE VIEW

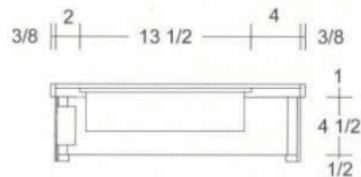



Project _____

Item # _____ Quantity _____

Model # _____

Custom Cabinet with Built-In Induction
Warmer & SmartStone®

Shipping Dimensions:

Single Unit Shipping Carton				
Model #	Length	Width	Height	Weight
SRC-181SS (US)	22.0"	19.0"	7.5"	13.0 lb.

Notes & Conditions:

1. SRC Tabletop Induction units are customizable units.
2. Actual range temperature may vary due to a number of variables, such as ambient temperature in the immediate surrounding area, content and volume of food being heated or cooked, and whether or not you are using a cover on the serving vessel.
3. This induction range requires use of ferrous metal, induction-ready cookware.
4. Spring USA Induction Servers and Induction Warmers/Ranges are designed to work together as a system. Optimal performance is achieved by using Spring USA components in conjunction with each other. As the first to offer such induction systems, Spring USA cannot warranty the performance of facsimile products offered by other companies.